

Liaison RD901 - RD52

Contournement Sud de Samer

**DOSSIER D'AUTORISATION
ENVIRONNEMENTALE UNIQUE**

Annexe 11

ruisseau de la Bernardière

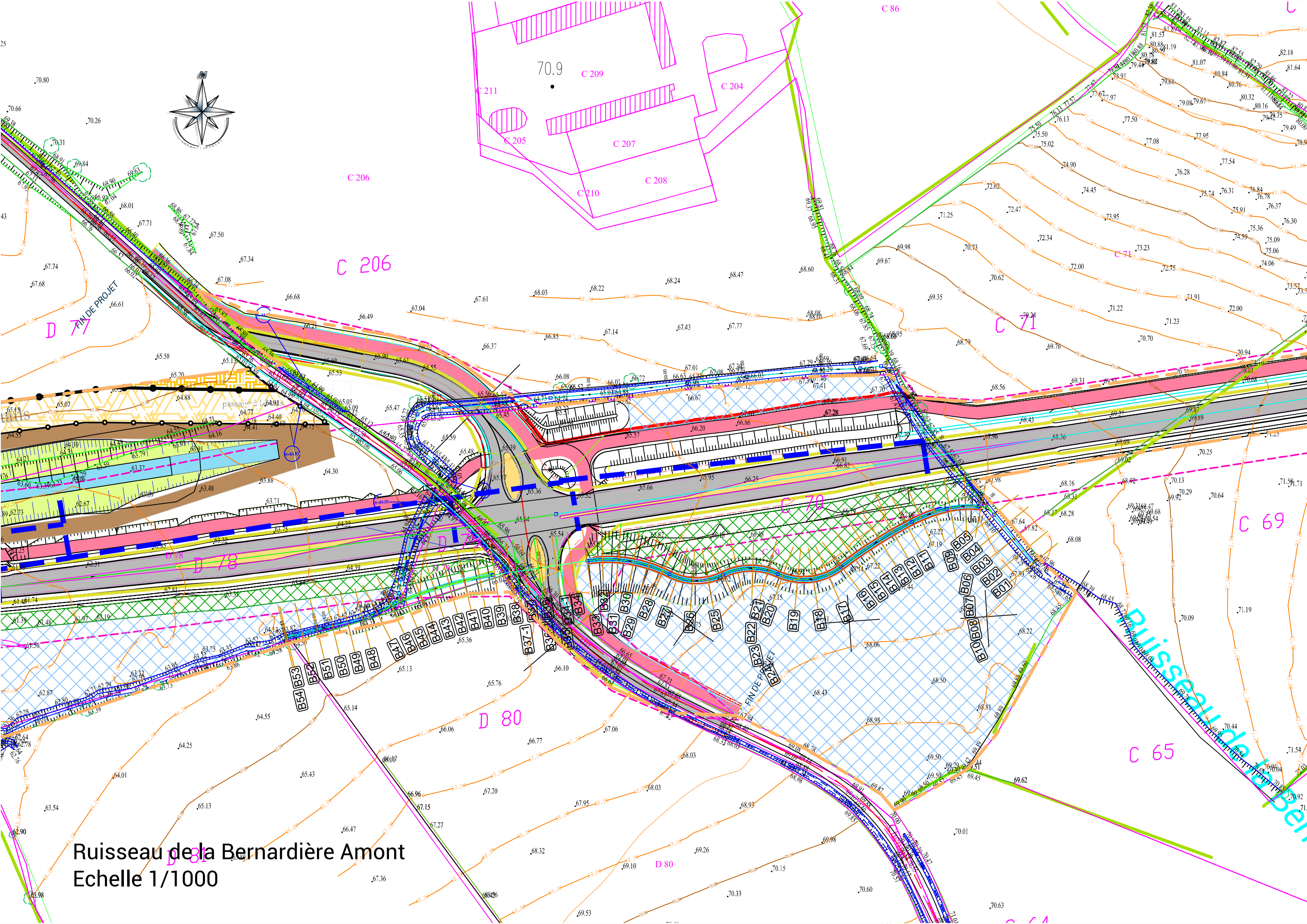

Ruisseau de la Bernardière Amont
Echelle 1/1000

C 206

70.9 C 209

C 205

C 207

C 204

C 210

C 208

D 76

D 78

D 80

D 80

C 71

C 69

C 65

C 86

C 70

C 72

C 73

C 74

C 75

C 76

C 77

C 78

C 79

C 80

C 81

C 82

C 83

C 84

C 85

C 86

C 87

C 88

C 89

C 90

C 91

C 92

C 93

C 94

C 95

C 96

C 97

C 98

C 99

C 100

C 101

C 102

C 103

C 104

C 105

C 106

C 107

C 108

C 109

C 110

C 111

C 112

C 113

C 114

C 115

C 116

C 117

C 118

C 119

C 120

C 121

C 122

C 123

C 124

C 125

C 126

C 127

C 128

C 129

C 130

C 131

C 132

C 133

C 134

C 135

C 136

C 137

C 138

C 139

C 140

C 141

C 142

C 143

C 144

C 145

C 146

C 147

C 148

C 149

C 150

C 151

C 152

C 153

C 154

C 155

C 156

C 157

C 158

C 159

C 160

C 161

C 162

C 163

C 164

C 165

C 166

C 167

C 168

C 169

C 170

C 171

C 172

C 173

C 174

C 175

C 176

C 177

C 178

C 179

C 180

C 181

C 182

C 183

C 184

C 185

C 186

C 187

C 188

C 189

C 190

C 191

C 192

C 193

C 194

C 195

C 196

C 197

C 198

C 199

C 200

C 201

C 202

C 203

C 204

C 205

C 206

C 207

C 208

C 209

C 210

C 211

C 212

C 213

C 214

C 215

C 216

C 217

C 218

C 219

C 220

C 221

C 222

C 223

C 224

C 225

C 226

C 227

C 228

C 229

C 230

C 231

C 232

C 233

C 234

C 235

C 236

C 237

C 238

C 239

C 240

C 241

C 242

C 243

C 244

C 245

C 246

C 247

C 248

C 249

C 250

C 251

C 252

C 253

C 254

C 255

C 256

C 257

C 258

C 259

C 260

C 261

C 262

C 263

C 264

C 265

C 266

C 267

C 268

C 269

C 270

C 271

C 272

C 273

C 274

C 275

C 276

C 277

C 278

C 279

C 280

C 281

C 282

C 283

C 284

C 285

C 286

C 287

C 288

C 289

C 290

C 291

C 292

C 293

C 294

C 295

C 296

C 297

C 298

C 299

C 300

C 301

C 302

C 303

C 304

C 305

C 306

C 307

C 308

C 309

C 310

C 311

C 312

C 313

C 314

C 315

C 316

C 317

C 318

C 319

C 320

C 321

C 322

C 323

C 324

C 325

C 326

C 327

C 328

C 329

C 330

C 331

C 332

C 333

C 334

C 335

C 336

C 337

C 338

C 339

C 340

C 341

C 342

C 343

C 344

C 345

C 346

C 347

C 348

C 349

C 350

C 351

C 352

C 353

C 354

C 355

C 356

C 357

C 358

C 359

C 360

C 361

C 362

C 363

C 364

C 365

C 366

C 367

Profil en long : Bernardiere Amont

Echelle en X : 1/1000
Echelle en Y : 1/100

PC : 55.00 m

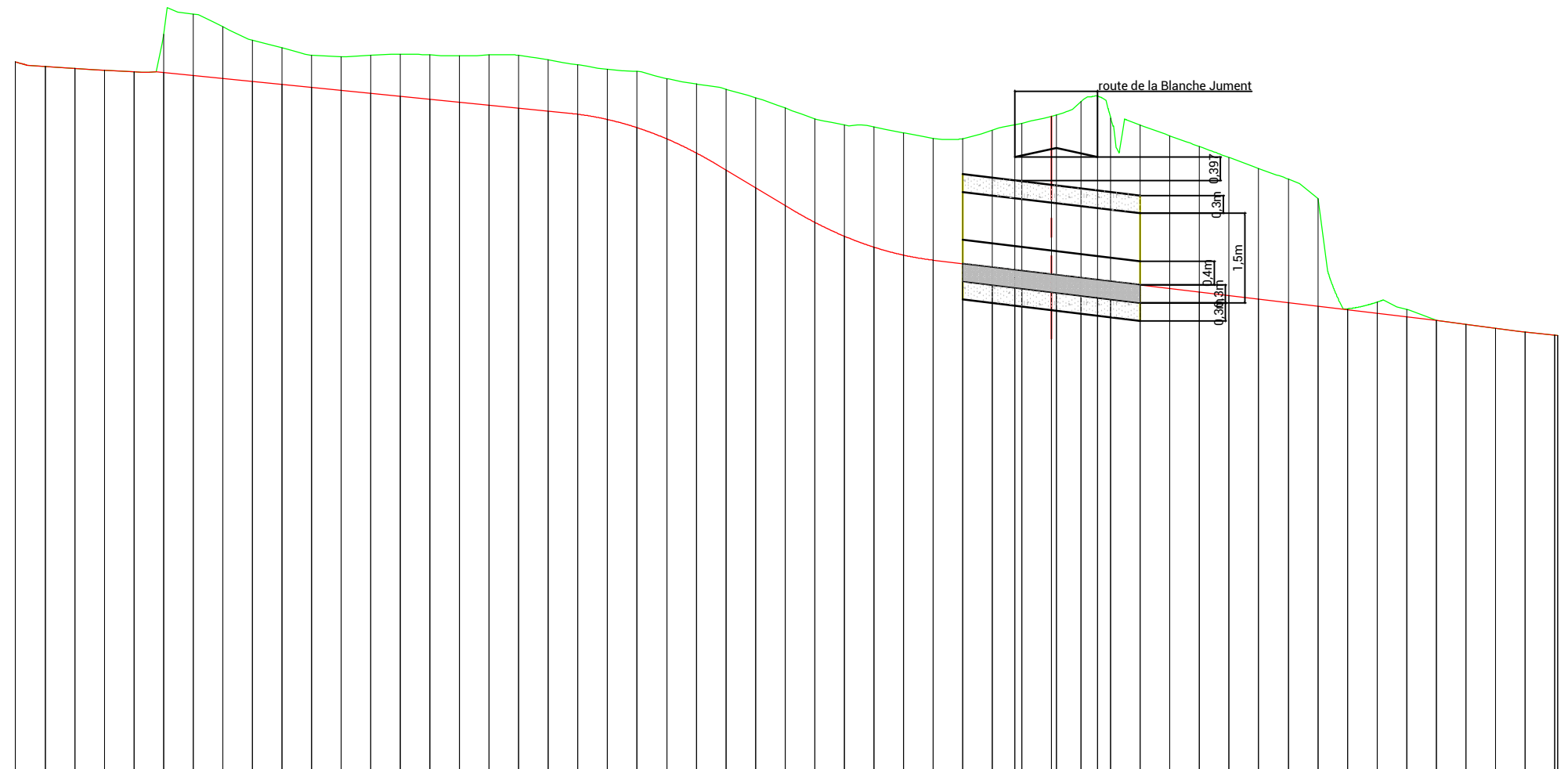

Numéro des profils	B01B02B03B04B05B06B07B08B09B10B11B12B13B14B15B16B17B18B19B20B21B22B23B24B25B26B27B28B29B30B31B32B33B34-1B36B37B38B39B40B41B42B43B44B45B46B47B48B49B50B51B52B54																																																						
Altitudes TN	66.97	66.90	66.86	66.83	66.80	67.44	67.78	67.56	67.34	67.21	67.08	67.06	67.08	67.10	67.09	67.07	67.09	67.08	67.01	66.92	66.84	66.81	66.69	66.60	66.51	66.37	66.19	66.01	65.90	65.87	65.77	65.68	65.67	65.82	65.91	66.05	66.30	66.39	66.03	65.91	65.72	65.54	65.35	65.17	64.99	64.66	62.80	62.91	62.79	62.61	62.54	62.47	62.41	62.35	
Altitudes Projet	66.97	66.90	66.86	66.83	66.80	66.79	66.74	66.69	66.64	66.59	66.54	66.49	66.44	66.39	66.34	66.29	66.24	66.19	66.14	66.09	66.00	65.86	65.67	65.43	65.14	64.85	64.55	64.26	64.03	63.84	63.71	63.62	63.56	63.50	63.46	63.38	63.32	63.29	63.26	63.20	63.14	63.08	63.02	62.96	62.90	62.84	62.78	62.72	62.66	62.60	62.54	62.47	62.41	62.35	
Ecart TN - Projet	0.00	0.00	0.00	-0.00	-0.00	0.65	1.04	0.88	0.70	0.62	0.54	0.57	0.64	0.71	0.75	0.79	0.85	0.89	0.87	0.83	0.85	0.95	1.02	1.17	1.37	1.52	1.65	1.75	1.88	2.03	2.07	2.06	2.11	2.31	2.45	2.67	2.98	3.10	3.27	2.70	2.58	2.46	2.33	2.21	2.08	1.82	0.02	0.19	0.12	0.00	0.00	0.00	0.00	0.00	0.00
Distances partielles	5.00	5.00	5.00	5.00	5.00	5.00	5.00	5.00	5.00	5.00	5.00	5.00	5.00	5.00	5.00	5.00	5.00	5.00	5.00	5.00	5.00	5.00	5.00	5.00	5.00	5.00	5.00	5.00	5.00	5.00	5.00	5.00	5.00	3.81	6.19	5.00	2.81	2.19	2.77	5.00	5.00	5.00	5.00	5.00	5.00	5.00	5.00	5.00	5.00	5.00	5.00	5.49			
Distances cumulées	0.00	5.00	10.00	15.00	20.00	25.00	30.00	35.00	40.00	45.00	50.00	55.00	60.00	65.00	70.00	75.00	80.00	85.00	90.00	95.00	100.00	105.00	110.00	115.00	120.00	125.00	130.00	135.00	140.00	145.00	150.00	155.00	160.00	165.00	168.81	175.00	180.00	182.81	185.00	190.00	195.00	200.00	205.00	210.00	215.00	220.00	225.00	230.00	235.00	240.00	245.00	250.00	255.00	260.49	
Pentes et rampes	PENTE L = 18.15 m P = -0.64 %		PENTE L = 69.90 m P = -1.00 %													RC = -500.00 L = 24.94		PENTE L = 12.43 m P = -6.00 %		RC = 500.00 L = 23.96		PENTE L = 85.07 m P = -1.20 %										PENTE L = 14.00 m P = -1.34 %																							
Alignements droits et courbes (axe en plan)	DROITE L = 20.01 m		ARC R = 31.41 m L = 10.47 m		ARC R = 49.95 m L = 11.92 m		ARC R = 145.16 m L = 27.03 m			ARC R = 19.69 m L = 21.61 m		ARC R = 20.33 m L = 18.20 m		ARC R = 19.15 m L = 17.84 m		ARC R = 43.82 m L = 27.21 m		DROITE L = 30.67 m			ARC R = 116.88 m L = 38.28 m				DROITE L = 25.15 m																														

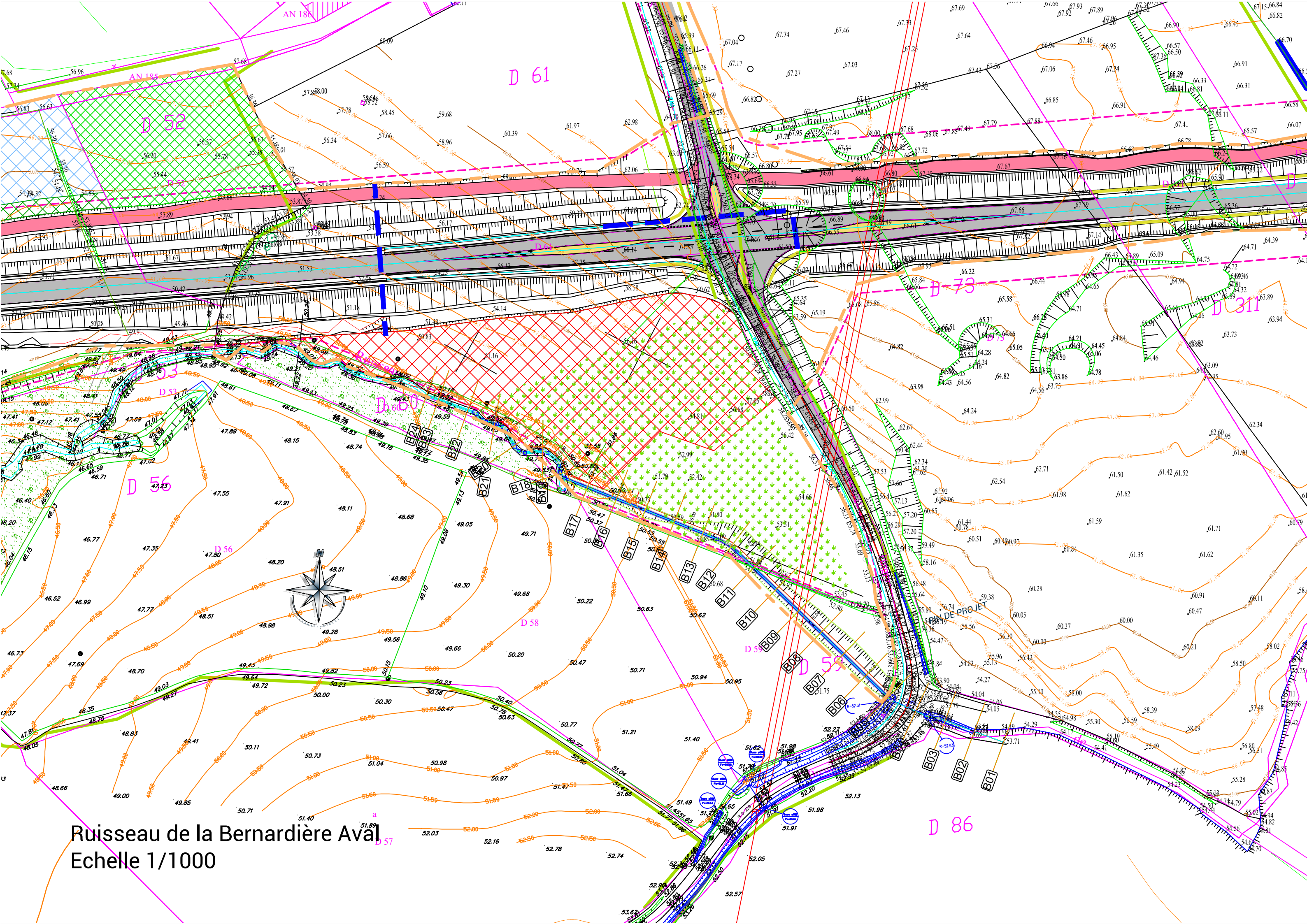

Ruisseau de la Bernardière Aval
Echelle 1/1000

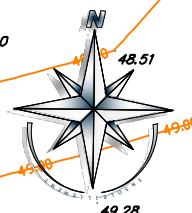

D 61

D 52

D 56

D 58

D 59

D 57

D 73

D 311

D 86

D 50

D 57

B 18

B 17

B 16

B 15

B 14

B 13

B 12

B 11

B 10

B 9

B 8

B 7

B 6

B 5

B 4

B 3

B 2

B 1

B 0

B -1

B -2

B -3

B -4

B -5

B -6

B -7

B -8

B -9

B -10

B -11

B -12

B -13

B -14

B -15

B -16

B -17

B -18

B -19

B -20

B -21

B -22

B -23

B -24

B -25

B -26

B -27

B -28

B -29

B -30

B -31

B -32

B -33

B -34

B -35

B -36

B -37

B -38

B -39

B -40

B -41

B -42

B -43

B -44

B -45

B -46

B -47

B -48

B -49

B -50

B -51

B -52

B -53

B -54

B -55

B -56

B -57

B -58

B -59

B -60

B -61

B -62

B -63

B -64

B -65

B -66

B -67

B -68

B -69

B -70

B -71

B -72

B -73

B -74

B -75

B -76

B -77

B -78

B -79

B -80

B -81

B -82

B -83

B -84

B -85

B -86

B -87

B -88

B -89

B -90

B -91

B -92

B -93

B -94

B -95

B -96

B -97

B -98

B -99

B -100

B -101

B -102

B -103

B -104

B -105

B -106

B -107

B -108

B -109

B -110

B -111

B -112

B -113

B -114

B -115

B -116

B -117

B -118

B -119

B -120

B -121

B -122

B -123

B -124

B -125

B -126

B -127

B -128

B -129

B -130

B -131

B -132

B -133

B -134

B -135

B -136

B -137

B -138

B -139

B -140

B -141

B -142

B -143

B -144

B -145

B -146

B -147

B -148

B -149

B -150

B -151

B -152

B -153

B -154

B -155

B -156

B -157

B -158

B -159

B -160

B -161

B -162

B -163

B -164

B -165

B -166

B -167

B -168

B -169

B -170

B -171

B -172

B -173

B -174

B -175

B -176

B -177

B -178

B -179

B -180

B -181

B -182

B -183

B -184

B -185

B -186

B -187

B -188

B -189

B -190

B -191

B -192

B -193

B -194

B -195

B -196

B -197

B -198

B -199

B -200

B -201

B -202

B -203

B -204

B -205

B -206

B -207

B -208

B -209

B -210

B -211

B -212

B -213

B -214

B -215

B -216

B -217

B -218

B -219

B -220

B -221

B -222

B -223

B -224

B -225

B -226

B -227

B -228

B -229

B -230

B -231

B -232

B -233

B -234

B -235

B -236

B -237

B -238

B -239

B -240

B -241

B -242

B -243

B -244

B -245

B -246

B -247

B -248

B -249

B -250

B -251

B -252

B -253

B -254

B -255

B -256

B -257

B -258

B -259

B -260

B -261

B -262

B -263

B -264

B -265

B -266

B -267

B -268

B -269

B -270

B -271

B -272

B -273

B -274

B -275

B -276

B -277

Profil en long : Bernardiere aval

busage sous RD238

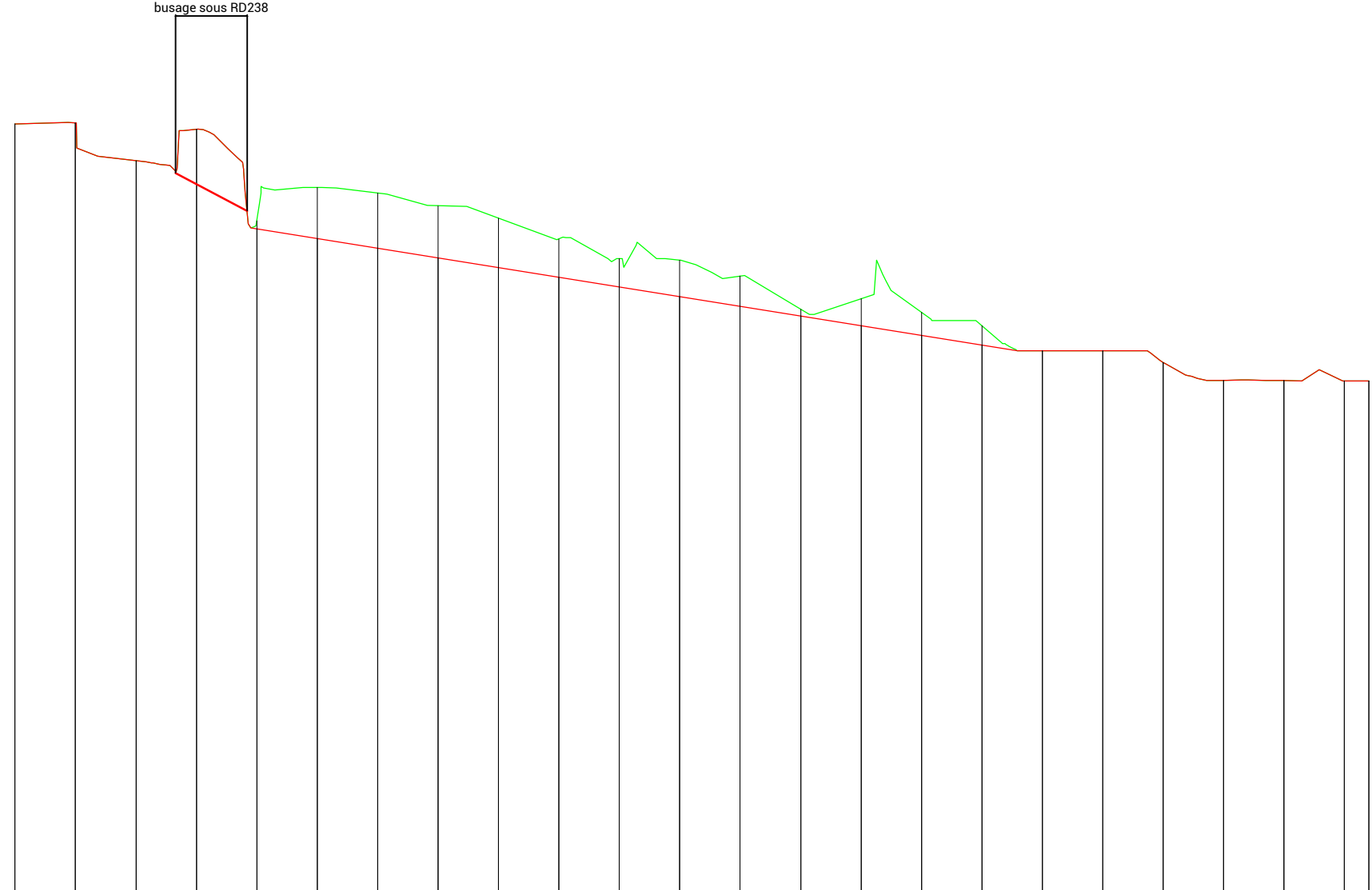

Echelle en X : 1/1000
Echelle en Y : 1/100

PC : 41.00 m

Numéro des profils	B01	B02	B03	B04	B05	B06	B07	B08	B09	B10	B11	B12	B13	B14	B15	B16	B17	B18	B19	B20	B21	B22	B23	B24	
Altitudes TN	53.75	53.77	53.14	53.66	52.15	52.70	52.61	52.40	52.19	51.85	51.52	51.50	51.23	50.69	50.86	50.63	50.41	50.00	50.00	49.80	49.51	49.51	49.50	49.50	
Altitudes Projet	53.75	53.77	53.14	53.66	52.01	51.85	51.69	51.53	51.37	51.21	51.05	50.89	50.73	50.57	50.41	50.25	50.09	50.00	50.00	49.80	49.51	49.51	49.50	49.50	
Ecart TN - Projet		0.00	-0.00	-0.00	0.14	0.85	0.92	0.86	0.82	0.64	0.47	0.61	0.50	0.11	0.44	0.38	0.32	0.00	0.00	0.00	0.00	-0.00	0.00	0.00	
Distances partielles		10.00	10.00	10.00	10.00	10.00	10.00	10.00	10.00	10.00	10.00	10.00	10.00	10.00	10.00	10.00	10.00	10.00	10.00	10.00	10.00	10.00	10.00	4.07	
Distances cumulées	0.00	10.00	20.00	30.00	40.00	50.00	60.00	70.00	80.00	90.00	100.00	110.00	120.00	130.00	140.00	150.00	160.00	170.00	180.00	190.00	200.00	210.00	220.00	224.07	
Pentes et rampes	RAMPE L = 8.76 m P = 0.33 %		PENTE L = 8.00 m P = -1.19 %		PENTE L = 126.89 m P = -1.60 %												RAMPE L = 21.49 m P = 0.00 %								
Alignements droits et courbes (axe en plan)	DROITE L = 21.69 m		DROITE L = 11.49 m		DROITE L = 68.03 m								ARC R = 20.00 m L = 7.77 m		DROITE L = 52.46 m							DROITE L = 16.22 m			

Profils en travers type du dévoiement du ruisseau de la Bernardière

Avant le chemin de la blanche jument

<< Sud

Nord >>

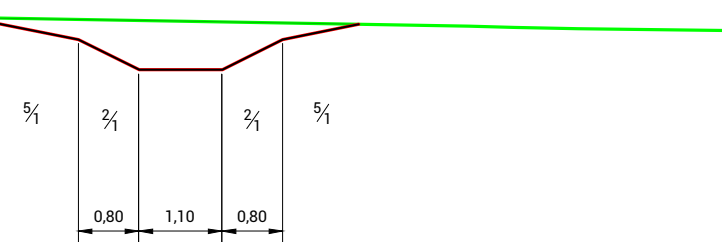

Après le chemin de la blanche jument

<< Sud

Nord >>

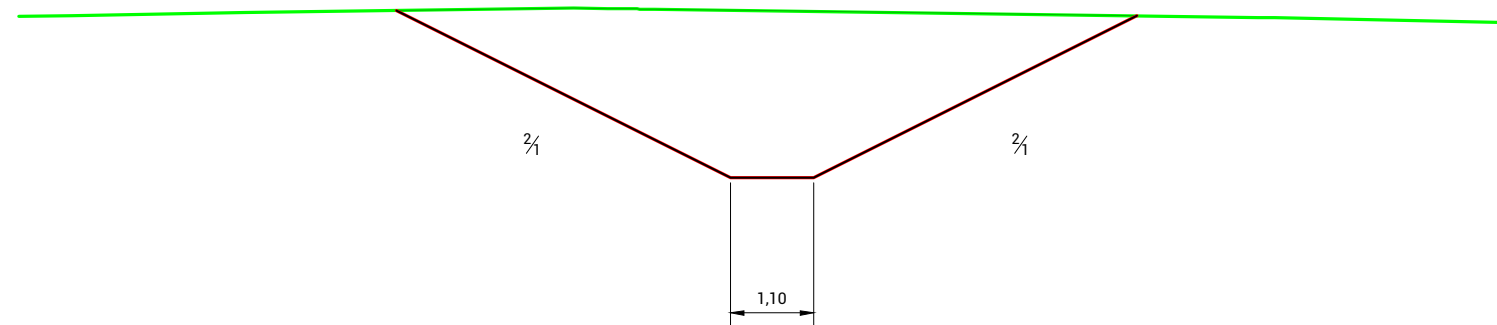

Après la RD238

<< Sud Ouest

Nord Est >>

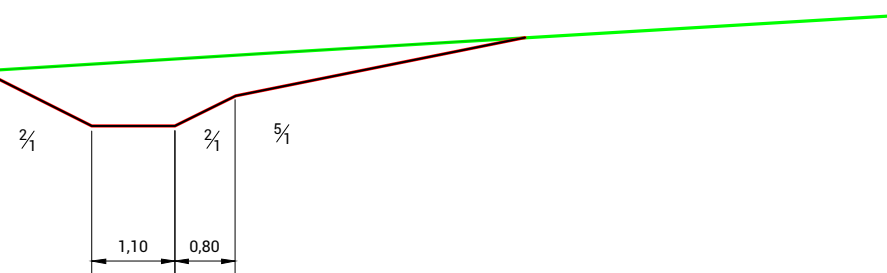

Echelle 1/100